

Thank you for choosing a Pinpoint Mounts product. Take your time and read the following instructions and information completely. Please keep these instructions in a safe place for future reference. If you sell the device, please pass these operating instructions on to the new owner.

**1. Explanation of Warning Symbols and Notes**

**Warning**

This symbol is used to indicate safety instructions or to draw your attention to specific hazards and risks.

**Note**

This symbol is used to indicate additional information or important notes.

**2. Package Contents**

- Speaker Wall Mount
- Installation kit
- These operating instructions

**Note**

Please check that this Mount assembly set is complete before installation and ensure that none of the parts are damaged or missing.

**3. Safety Notes**

**Warning**

- Please note that the supplied wall plugs are for use with concrete brick and solid brick walls only.
  - If the wall on which the bracket is to be mounted is made of different material types and construction types to those specified, purchase suitable mounting materials from a specialised dealer.
  - If in doubt, have this product mounted by a qualified technician - do not attempt to mount it yourself!
  - Ensure that electrical cables are not crushed or damaged during installation.
  - Do not mount the product above locations where persons might linger.
  - Once you have mounted the product and the attached load, check that they are sufficiently secure and safe to use.
  - You should repeat this check at regular intervals (at least every three months).
  - When doing so, ensure that the product does not exceed its maximum permitted carrying capacity and that no load exceeding the maximum permitted dimensions is attached.
  - Make sure that the product is loaded symmetrically.
  - Maintain the necessary safety clearance around the attached load (depending on the model).
  - In the event of damage to the product, remove the attached load and stop using the product.
- 4. Installation requirements and installation**
- Observe the other warnings and safety instructions.
  - Proceed step-for-step in accordance with the illustrated installation instructions (Fig. 1a ff.).
- 5. Setting and maintenance**
- Check that the bracket is secure and safe to use at regular intervals (at least every three months). Only clean with water or standard household cleaners.
  - Screws do not have to be loosened to adjust the angle.

**6 Warranty Disclaimer**

Pinpoint Mounts assumes no liability and provides no warranty for damage resulting from improper installation/mounting, improper use of the product or from failure to observe the operating instructions and/or safety notes.

**7. Service and Support**

Please contact Pinpoint Mounts product support if you have any questions about this product.  
 Hotline: 866.343.0548 (Mon - Fri 9am - 5pm Central Time)  
 Further support information can be found here:  
[www.pinpointmounts.com](http://www.pinpointmounts.com) | [support@pinpointmounts.com](mailto:support@pinpointmounts.com)

All listed brands are trademarks of the corresponding companies. Errors and omissions excepted, and subject to technical changes. This product is protected by Patent and/or Design copyrights.



**AM45LCR.F**  
**AM45LCR.FH**

**SPEAKER WALL MOUNT | FLUSH MOUNT**

**UNIVERSAL FIT** | **AM45LCR.F MAX WEIGHT 15 lbs (6.80kg)**  
**AM45LCR.FH MAX WEIGHT 25 lbs (11.33kg)**

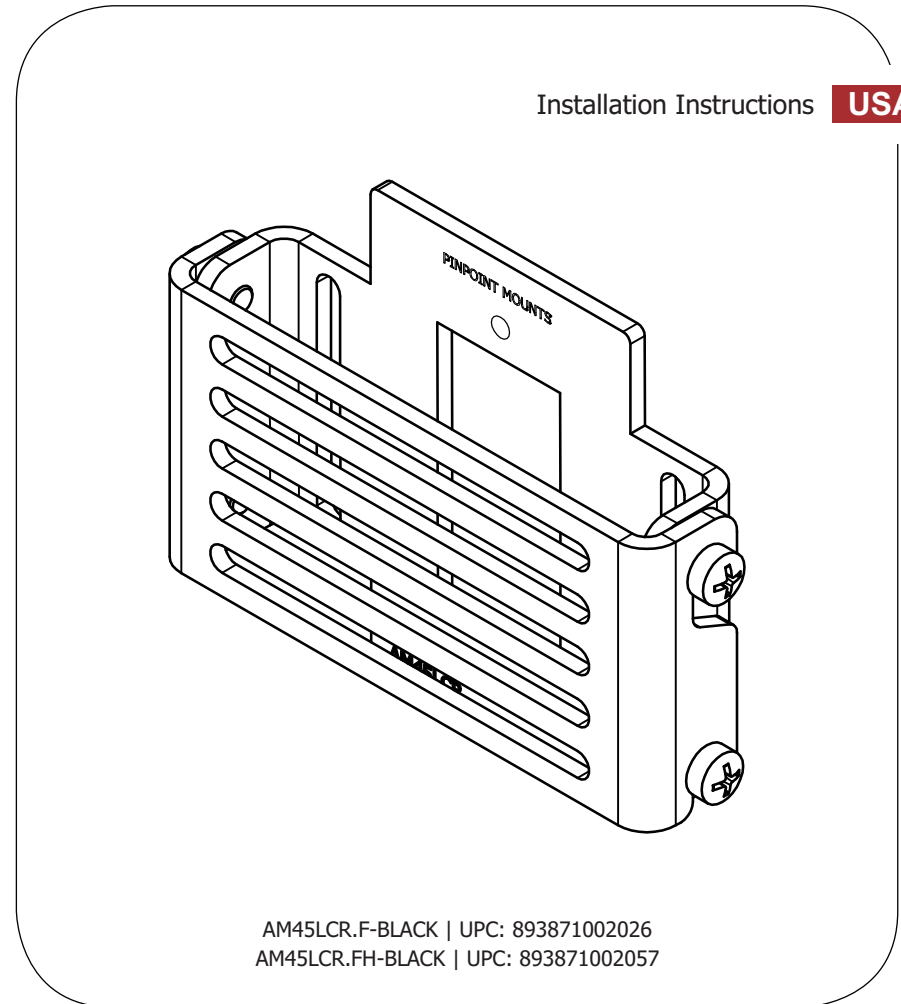

### Required tools



### Installation kit

	(A1) AM45LCR Wall Plate (x1)		(B1) 1/4" x .50" Machine Screw (x2)
			(B2) 1/4" x .75" Machine Screw (x2)
			(B3) M6 x 14mm Machine Screw (x2)
	(A2) AM45LCR Speaker Plate (x1)		(B4) M6 x 20mm Machine Screw (x2)
			(C1) 6-32" x .75" Machine Screw (x2)
			(C2) Keyhole Adapter (x2)
	(A3) 1/4" x .35" Machine Screw (x4)		(C3) 1/4" Washer (x2)
	(A4) 6-32" x 1" Machine Screw (x2)		(C4) Plastic Spacer (x2)
	(A5) #8 x 1.5" Wood Screw (x2)		(D1) 3/8" - 1/4" Thread Reducer (x2)

#### Warning

Metric & US Standard screw sizes are similar in size by have different thread pitch. Selecting the correct screw type is important to avoid damage to the mounting point of the speaker. The Screw should turn easily by hand all the way to the bottom of the threading without resistance. If the screw does not thread easily and/or stops within a couple of turns, the screw is not the correct one. Never force the screw and only use a hand screwdriver to tighten.

#### Note

This Mount comes with the most common Screw sizes used for mounting Speakers but some speakers may require other sizes and/or may need longer/shorter screws than what is provided. In most cases, these sizes can be found at any home improvement store. If you need assistance, please contact our customer support.

#### Warning

This Mounting Bracket is designed to fit over a standard Single Gang Hi/Lo Volt Electrical Box pre-wired for Home Audio/Video that is fastened to a wood Wall Stud. The Maximum Weight Rating is **ONLY** possible when the Wall Plate (A1) is secured to a Wood Stud. If installing to a Box **NOT** fastened to a wood stud, the Maximum Weight Rating is one half (1/2) of the listed Rating. **Do NOT exceed the Maximum weight handling of this Mount.**

#### Note

The opening of the Wall Plate (A1) will allow the use of any standard Decora Style Single Insert such as Speaker Binding Posts (Pinpoint model AVBP2). Please note, the use of Banana Plugs/jacks may not work due to the low profile of this Mount.

#### Note

This Mount is designed to work with any standard mounting point found on the back of a speaker for wall mounting. Please see the Speaker Plate (A2) Diagram on Page 3 for Maximum width of Dual (Double) mounting points.

#### Note

The Maximum diameter Machine screw that can be used is 1/4" (6mm). For speakers requiring a 3/8" diameter, please use the included Adapter (D1).

If you have any questions about this product, please contact  
Customer Support prior to installation.

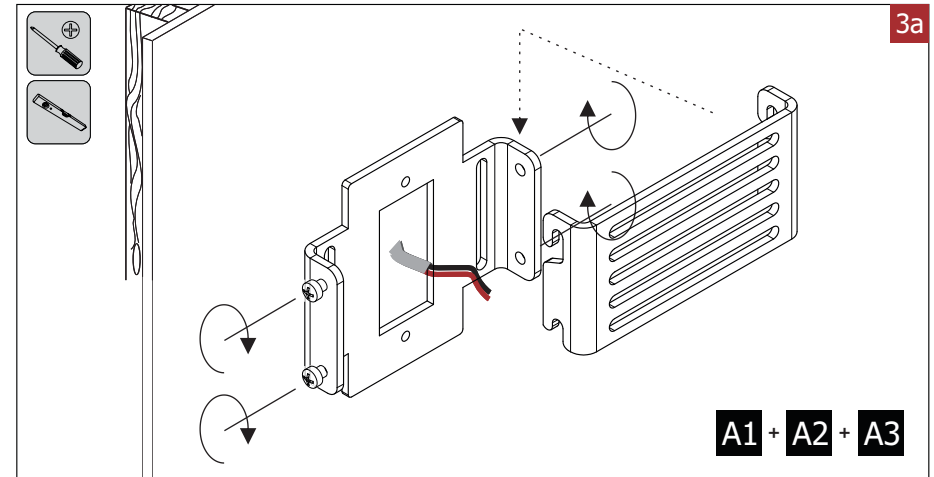

#### Note

Make sure that the screws (A3) are tightened to prevent vibration and/or the speaker from coming off the Wall Plate (A1).

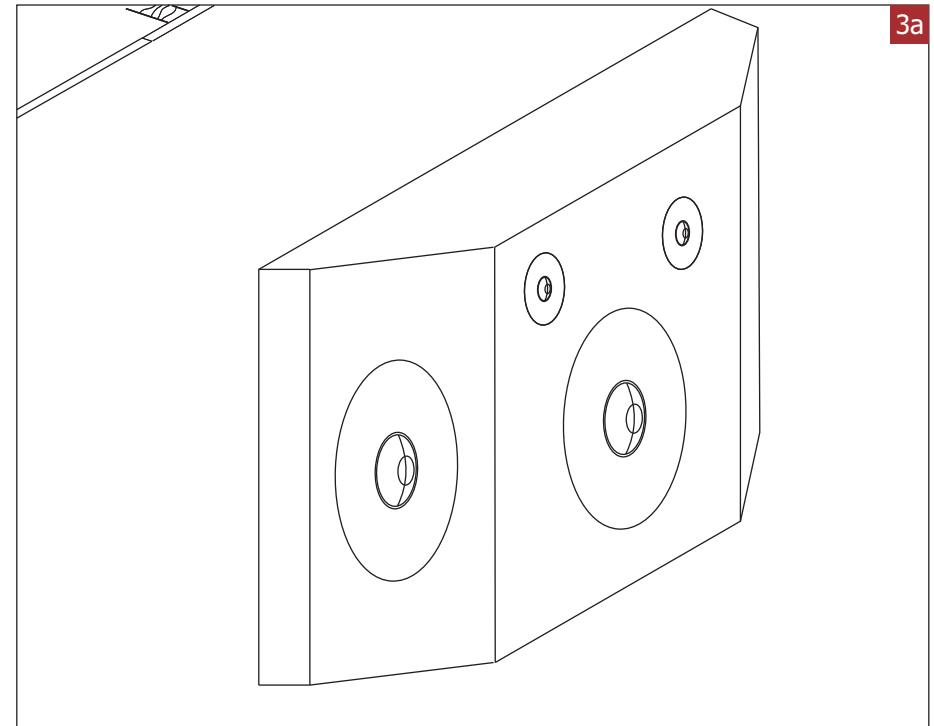

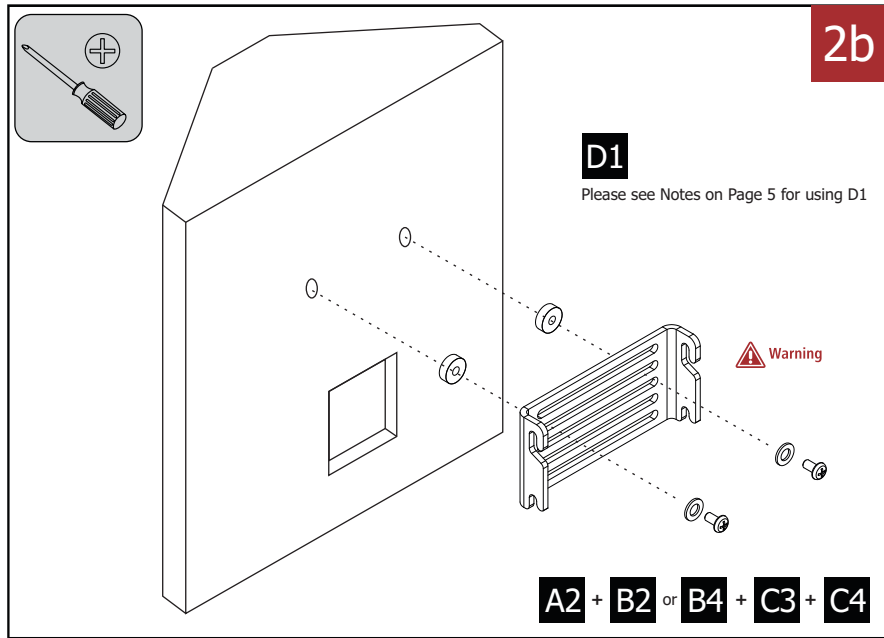

**Note**  
This Mounting Option is the same for Speakers that have only a Single (1) Threaded Mounting Hole. Simply use only one (1) of each part needed.

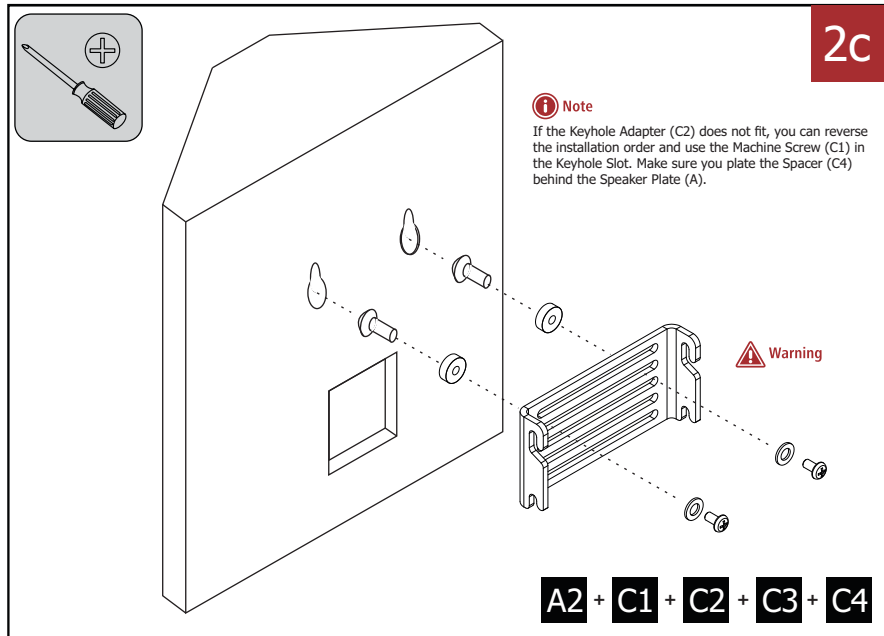

**Note**  
This Mounting Option is the same for Speakers that have only a Single (1) Keyhole Mounting Point. Simply use only one (1) of each part needed.

(A1) AM45LCR Wall Plate

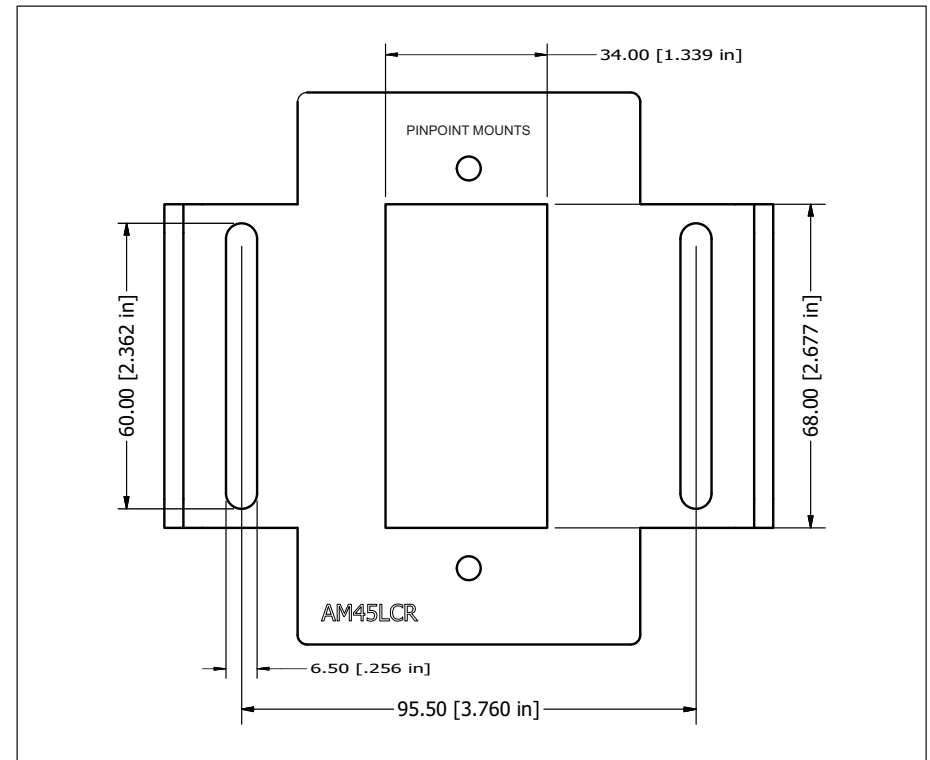

(A2) AM45LCR Speaker Plate

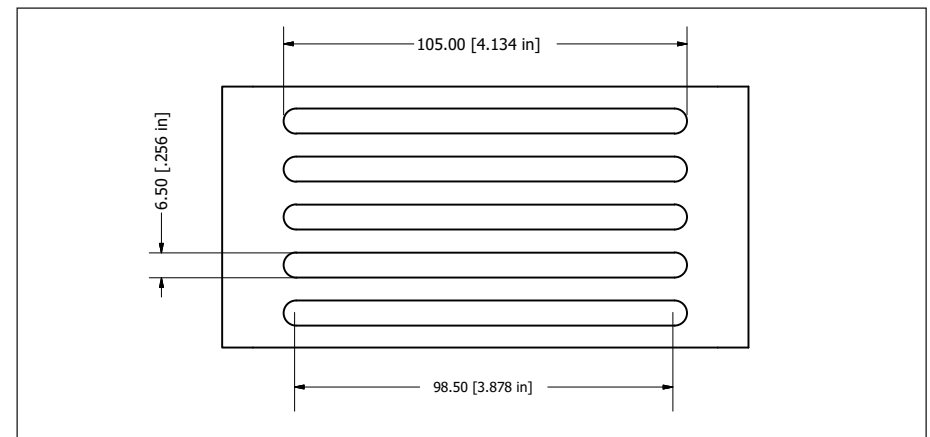

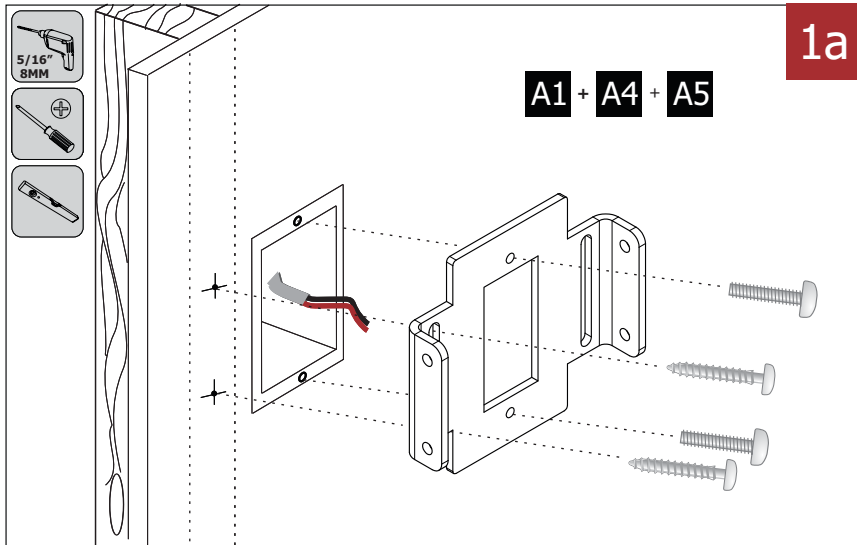

**Warning**

When Mounting this bracket, attach the Wall Plate (A1) to the Electrical Box before marking the Locations for the two (2) Wood Screws (A). Always Pre-Drill the holes for the Wood Screws (A) to avoid stripping or breaking the Head of the Wood Screws.

**Note**

This Mount can be mounted to locations WITHOUT an Electrical Box by using two (2) Drywall Anchors (Not Included) on the other side of the wood stud. The Maximum Weight Handling is reduced by one half (1/2) of the listed rating when only fastening to a single wood stud without Anchors/Electrical Box or using only Drywall Anchors.

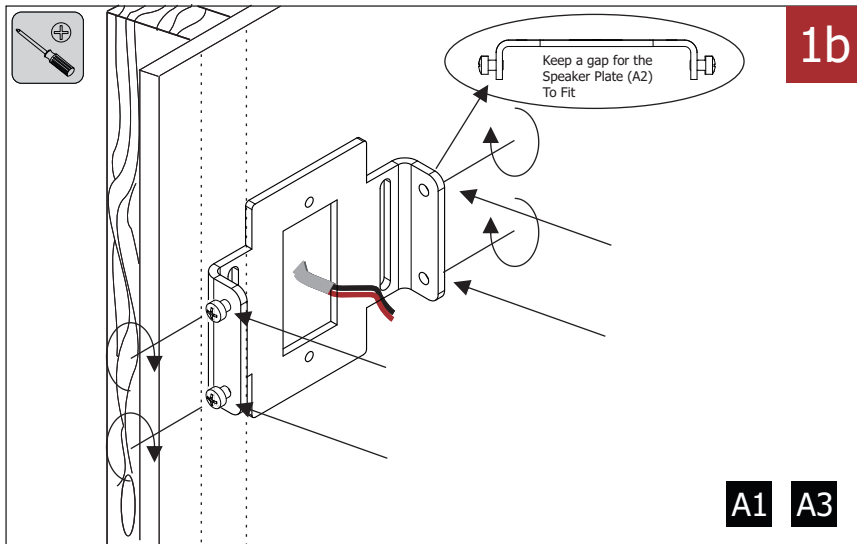

**Note**

When tightening the support 1/4" Machine Screws (A) to the Wall Plate (A1), Make sure you leave a gap wide enough to allow the Speaker Plate (A2) to fit on the Wall Plate (A1) securely, but without having to force it on. Test this fitting prior to Mounting the Speaker onto the Speaker Plate (A).

## MOUNTING THE SPEAKER TO THE SPEAKER PLATE

The following Instructions will show the most common types of installation methods for attaching this Mounting Bracket to a Speaker. Not all possible installations are listed and your speaker may require additional steps not shown in this Manual. If you are unsure of the proper method or need additional assistance, please contact Customer Support.

**Note**

This Speaker Plate has five (5) Mounting slots that can be used when attaching the speaker. These slots allows for precise placement of the speaker and clearance for Wire Terminals, Rear Ports or Ceiling. You may use any of the five (5) slots that fits best for your installation and/or application. The majority of speakers are compatible with this Mounting bracket, but in the rare case this Bracket does not work for an installation, please contact Customer Support for additional options.

**Note**

If the speaker requires a 3/8" screw, use the Thread Reducer (D1) by inserting it into the threaded hole in the speaker using a slot blade screwdriver till tight. Continue installation as shown in the instructions as noted.

**Note**

This Mount comes with the most common Screw sizes used for mounting Speakers but some speakers may require other sizes and/or may need longer/shorter screws than what is provided. In most cases, these sizes can be found at any home improvement store. If you need assistance, please contact our customer support.

**Warning**

Metric & US Standard screw sizes are similar in size by have different thread pitch. Selecting the correct screw type is important to avoid damage to the mounting point of the speaker. The Screw should turn easily by hand all the way to the bottom of the threading without resistance. If the screw does not thread easily and/or stops within a couple of turns, the screw is not the correct one. Never force the screw and only use a hand screwdriver to tighten.

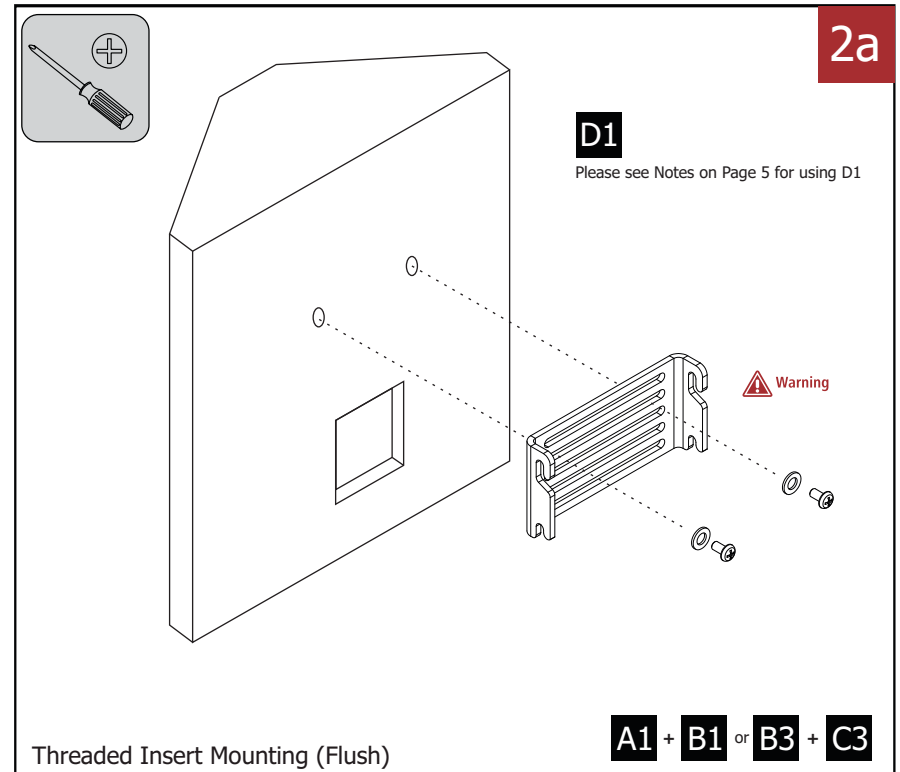

**Note**

This Mounting Option is the same for Speakers that have only a Single (1) Threaded Mounting Hole. Simply use only one (1) of each part needed.